

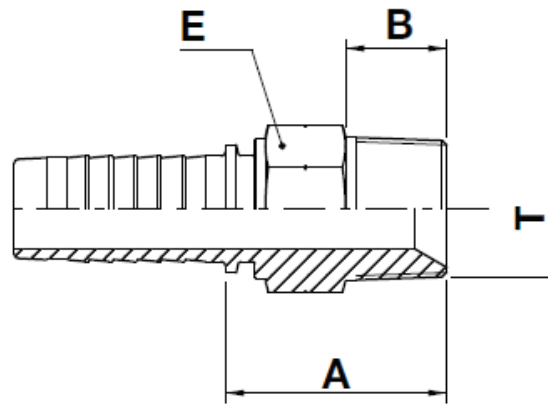

F-PM

NPT Male



USE WITH TEXCEL HOSE SERIES

HB3K, HB3K-XT, HB4K, HB4KXT, HB5K, HB5K-XT, HB6K, HBR1, HBR2, HHT2, HS3K, HS4K, HS5K, HS5KXT, HS6K

TWO-PIECE NO-SKIVE FITTING INSERT

| CODE | SIZE | HOSE | | THREAD SIZE | A | | B | | E | | | Box Qty |
|-----------|------|------|----|-------------|------|------|------|------|------|---------|------|---------|
| | | INCH | DN | | [in] | [mm] | [in] | [mm] | [in] | ↗[in] | [mm] | |
| F-0402-PM | 04 | ¼ | 6 | ⅛" - 27 | 0.87 | 22.0 | 0.38 | 9.6 | 0.55 | 9/16 | 14.0 | 200 |
| F-0404-PM | 04 | ¼ | 6 | ¼" - 18 | 1.04 | 26.5 | 0.55 | 14.0 | 0.55 | 9/16 | 14.0 | 300 |
| F-0406-PM | 04 | ¼ | 6 | ⅜" - 18 | 1.10 | 28.0 | 0.55 | 14.0 | 0.75 | ¾ | 19.0 | 200 |
| F-0604-PM | 06 | ⅜ | 10 | ¼" - 18 | 1.04 | 26.5 | 0.55 | 14.0 | 0.67 | 11/16 | 17.0 | 200 |
| F-0606-PM | 06 | ⅜ | 10 | ⅜" - 18 | 1.10 | 28.0 | 0.55 | 14.0 | 0.75 | ¾ | 19.0 | 150 |
| F-0608-PM | 06 | ⅜ | 10 | ½" - 14 | 1.30 | 33.0 | 0.75 | 19.0 | 0.87 | 7/8 | 22.0 | 100 |
| F-0806-PM | 08 | ½ | 12 | ⅜" - 18 | 1.12 | 28.5 | 0.55 | 14.0 | 0.75 | ¾ | 19.0 | 100 |
| F-0808-PM | 08 | ½ | 12 | ½" - 14 | 1.32 | 33.5 | 0.75 | 19.0 | 0.87 | 7/8 | 22.0 | 100 |
| F-0812-PM | 08 | ½ | 12 | ¾" - 14 | 1.34 | 34.0 | 0.75 | 19.0 | 1.06 | 1 1/16 | 27.0 | 80 |
| F-1008-PM | 10 | ⅝ | 16 | ½" - 14 | 1.32 | 33.5 | 0.75 | 19.0 | 0.95 | 15/16 | 24.0 | 80 |
| F-1212-PM | 12 | ¾ | 19 | ¾" - 14 | 1.63 | 41.5 | 0.75 | 19.0 | 1.06 | 1 1/16 | 27.0 | 40 |
| F-1216-PM | 12 | ¾ | 19 | 1" - 11 ½ | 1.83 | 46.5 | 0.94 | 24.0 | 1.42 | 1 7/16 | 36.0 | 30 |
| F-1616-PM | 16 | 1 | 25 | 1" - 11 ½ | 1.89 | 48.0 | 0.94 | 24.0 | 1.42 | 1 7/16 | 36.0 | 25 |
| F-2020-PM | 20 | 1 ¼ | 31 | 1 ¼" - 11 ½ | 2.48 | 63.0 | 0.96 | 24.5 | 1.81 | 1 13/16 | 46.0 | 25 |
| F-2424-PM | 24 | 1 ½ | 38 | 1 ½" - 11 ½ | 2.52 | 64.0 | 1.00 | 25.5 | 1.97 | 2 | 50.0 | 15 |
| F-3232-PM | 32 | 2 | 51 | 2" - 11 ½ | 3.11 | 79.0 | 1.02 | 26.0 | 2.56 | 2 5/16 | 65.0 | 5 |