

F-DLM

DKL Male

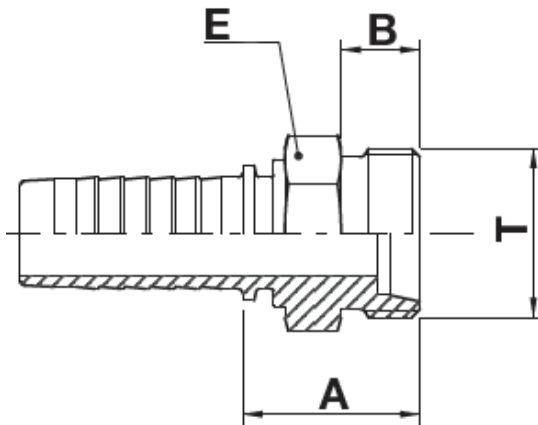

USE WITH TEXCEL HOSE SERIES

HB3K, HB3K-XT, HB4K, HB4KXT, HB5K, HB5K-XT, HB6K, HBR1, HBR2, HHT2, HS4K, HS5K, HS5KXT, HS6K

TWO-PIECE NO-SKIVE FITTING INSERT

CODE	HOSE			THREAD SIZE	TUBE SIZE	A		B		E		Box Qty	
	SIZE	INCH	DN			[in]	[mm]	[in]	[mm]	[in]	↗ [in]		[mm]
F-0412-DLM	04	¼	6	M12X1.5	6L	0.89	22.5	0.39	10.0	0.55	9/16	14.0	350
F-0414-DLM	04	¼	6	M14X1.5	8L	0.89	22.5	0.39	10.0	0.55	9/16	14.0	150
F-0416-DLM	04	¼	6	M16X1.5	10L	0.96	24.5	0.43	11.0	0.67	11/16	17.0	100
F-0616-DLM	06	3/8	10	M16X1.5	10L	0.96	24.5	0.43	11.0	0.67	11/16	17.0	200
F-0618-DLM	06	3/8	10	M18X1.5	12L	0.98	25.0	0.43	11.0	0.75	3/4	19.0	200
F-0622-DLM	06	3/8	10	M22X1.5	15L	1.02	26.0	0.47	12.0	0.87	7/8	22.0	150
F-0822-DLM	08	½	12	M22X1.5	15L	1.04	26.5	0.47	12.0	0.87	7/8	22.0	100
F-0826-DLM	08	½	12	M26X1.5	18L	1.14	29.0	0.47	12.0	1.06	1 1/16	27.0	75
F-1026-DLM	10	5/8	16	M26X1.5	18L	1.14	29.0	0.47	12.0	1.06	1 1/16	27.0	75